

iKydz App Update



Our iKydz app has had a facelift!

We've created a new version of our iKydz app for both Android and iOS. Use this guide to learn the basics.



Log in

Enter your email address and your PIN password that you supplied at registration

Forgotten your login details?

Click here to get help with logging in if you have forgotten your details

iKydz App Update



WIFI – Manage all your connected devices

WIFI tab lets you view and manage all devices connected to the iKydz network. It is the first screen that you will see when you log in - you cannot miss it!

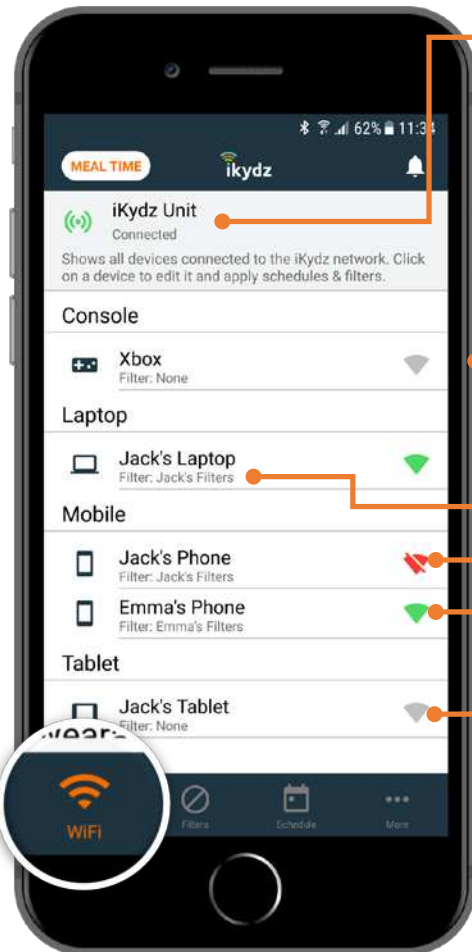

iKydz Unit

Shows you that your iKydz device is connected and working

Connected devices

WIFI tab shows all devices connected to your iKydz network. Click on each device to edit and manage it.



- Rename the device
- Apply filters
- Set YouTube restrictions
- Schedule time online

Filter

Shows you what Filter List is applied to each device

Online / Offline / Not connected

These symbols give you a quick view of the device status

-  Connected to iKydz with Internet Access
-  Connected to iKydz with **No** Internet Access
-  Not currently connected to iKydz network

iKydz App Update



Managing Devices

Click on any connected device to edit and manage it.

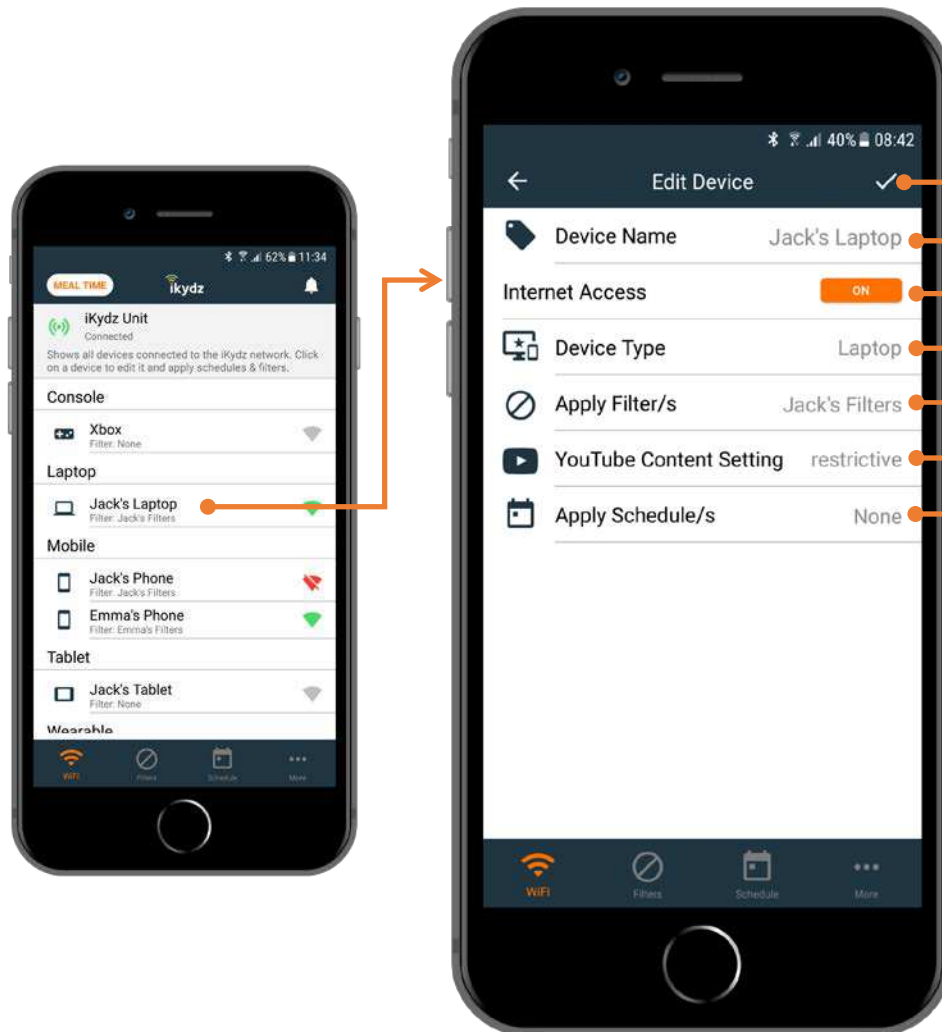

Save your changes here

Click here to edit the device name

Turn On/Off Internet access to the device.

Note that even if Internet Access is set to ON here, the device sometimes may not have Internet access if you have applied a specific Schedule to the device that limits Internet access at certain times.

Select the device type

Helps you to arrange and view your devices by type E.g. Laptop, Console, Mobile, Tablet, etc

Apply Filters

Select the filter that you want to apply to that device. You can only apply one filter list per device, but you can apply a filter list to many devices. If you don't have any filter lists set up, just go to Filters to create them.

Set YouTube Content

Choose the YouTube content setting for that device. You have a choice of 3: Restrictive, Moderate or None.

Apply Schedules

Select the schedules that you want to apply to that device. If you don't have any schedules set up, just go to Schedule to create them

iKydz App Update



FILTERS – Create and manage your Filter Lists

FILTERS tab replaces the My BlockLists function from our last iKydz app version. Create and customise filter lists for each of your kids and apply them easily to all of their devices.

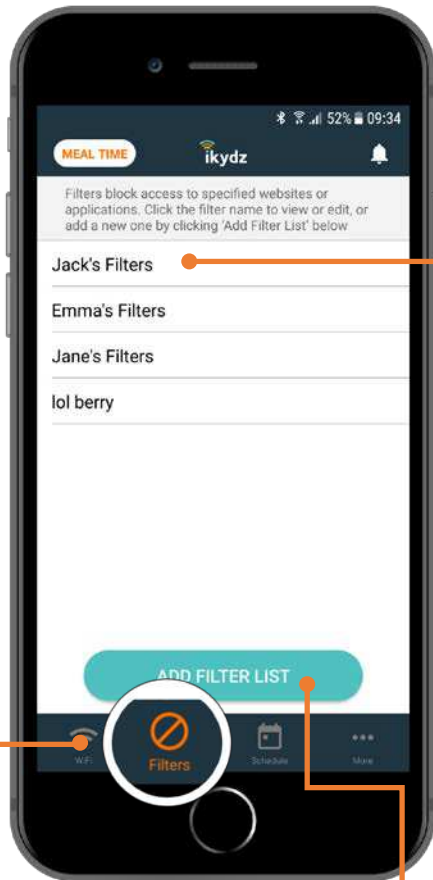

Add Filter List

Create a new Filter List for one of your kids by clicking here

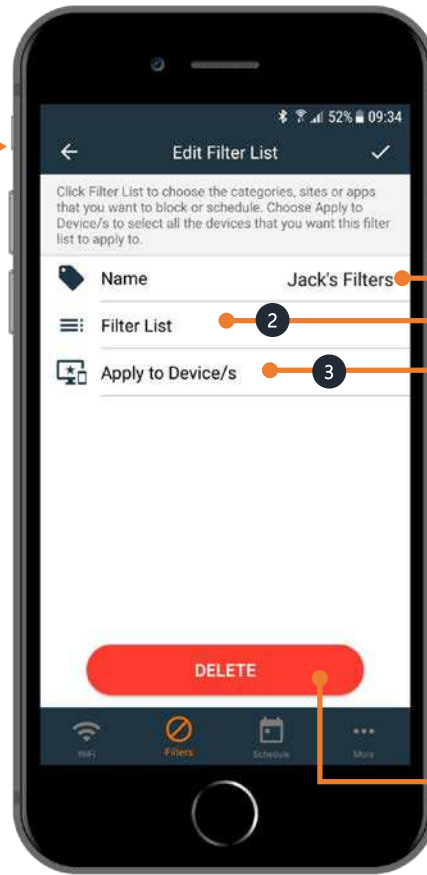

Delete Filter List

Delete individual Filter Lists by clicking this button

1 Edit the filter name
Click to edit the filter name

2 Filter Lists
Click Filter List and select the apps, websites or categories you want to Allow, Not Allow or Schedule access to.

3 Apply Filter
Select the devices to which you want to apply the Filter. You can apply one filter to multiple devices from the Filters tab.

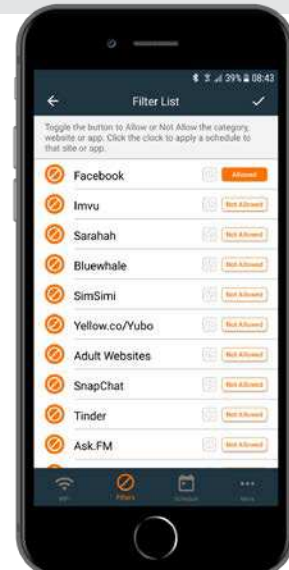
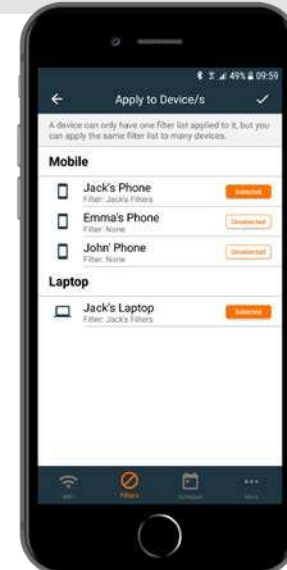

SCHEDULE – Create and manage your Schedules

Schedules indicate periods when you want your kids to have limited or no access to the Internet. Create multiple schedules and easily apply them to some or all of your kids' devices.

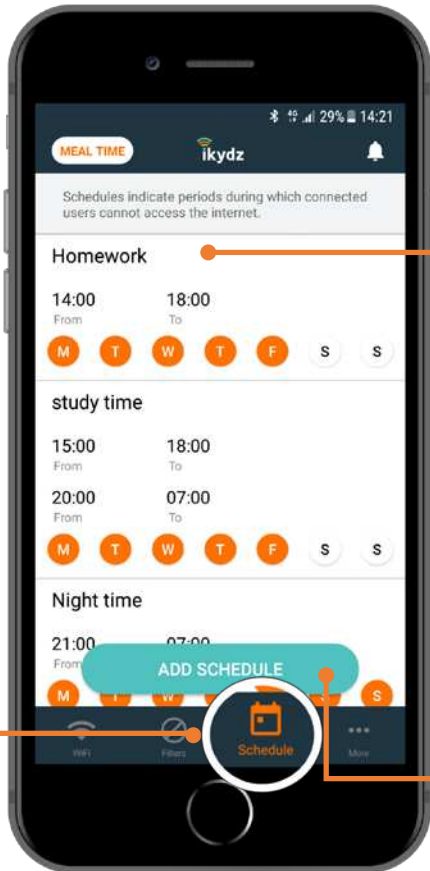

Add Schedule

Create a new Schedule by clicking here

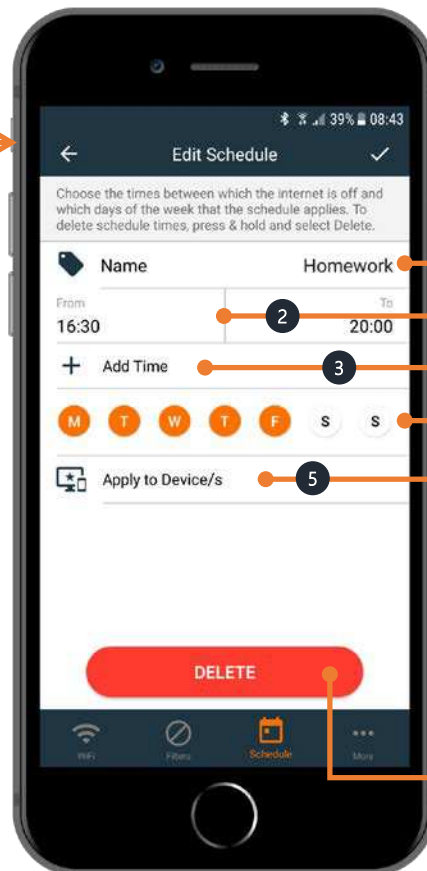

Delete Schedule

Delete individual Schedules by clicking this button

1 Edit the schedule name

Click to edit the schedule name

2 Edit Schedule Times

Schedules are active between the 'From' and 'To' times. That means no Internet or app/website access between those times.

3 Add Time

Set up to 2 blocks of time when the Schedule is applied.

4 Set days of week

Set the days of the week that the schedule is active. Orange means that the schedule applies on those days.

5 Apply to devices

Select the devices that you want to apply the schedule to.

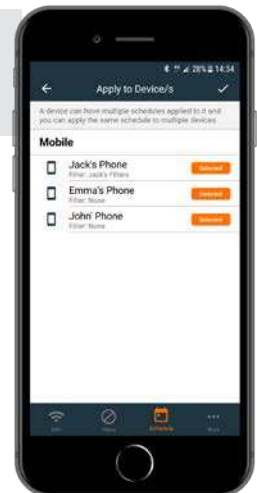

iKydz App Update



MEALTIME – Stop the Internet to all devices with one click!

Click the MEALTIME button to give everyone a break from the Internet. Internet access automatically returns after 30 minutes, or you can just click MEALTIME again if you want to turn it back on straightaway.

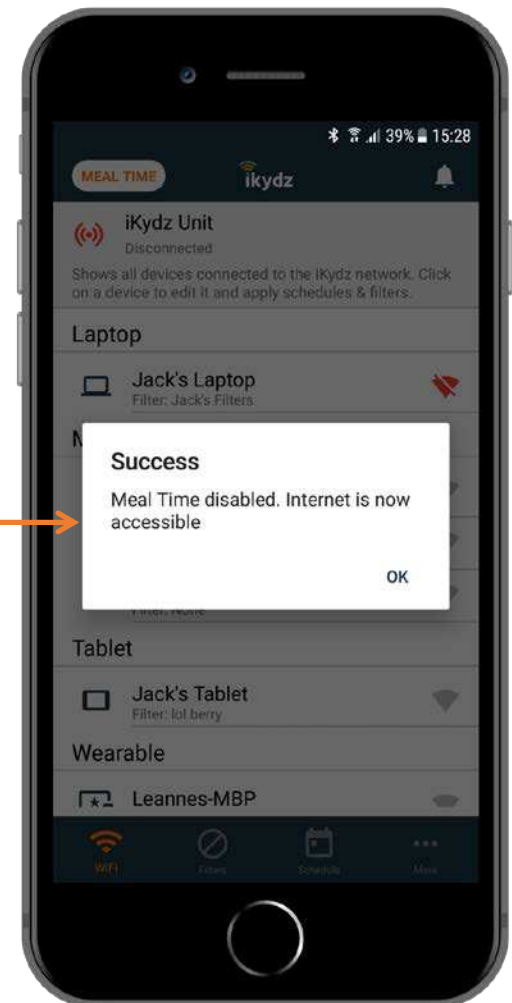
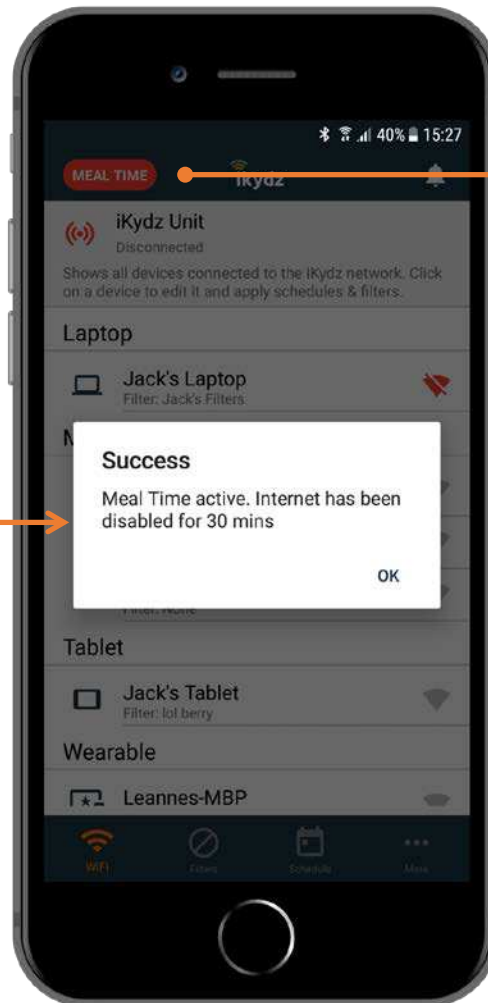

iKydz App Update



MORE – Your Account details, Terms & Conditions and Support

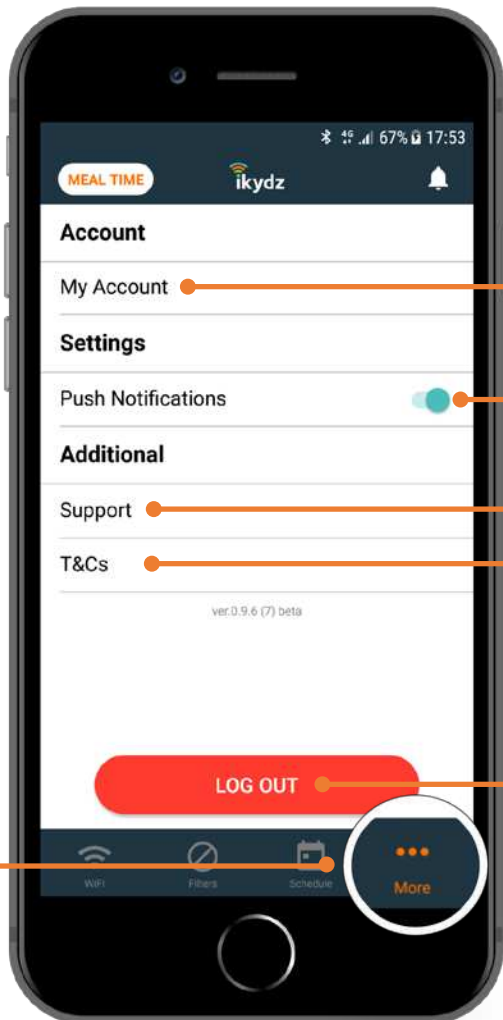

Notifications
Turn on/off notifications.

Support
Get brought straight to your iKydz Support options.

Terms and Conditions
Take a look at the iKydz terms and conditions.

Log Out
Log out of the iKydz app.

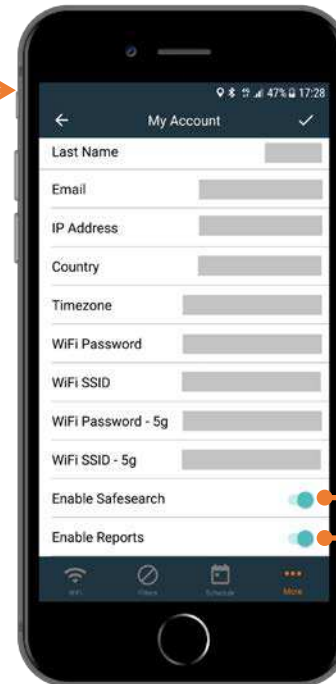

Enable Safesearch
Safesearch ensures that all web searches that are made on the iKydz network are routed through Safesearch.

This option is enabled by default. There should be no reason for you to disable this, but if you want to, this is the place to do it.

Enable Reports
Reports allow you to view the individual device usage, showing the top social media and other sites that a device has been viewing.

Reports are not enabled by default.

NEED MORE HELP?

Website: www.ikydz.com/support
Email: support@ikydz.com